

PTH300

OUTDOOR PAN & TILT

REVISION 0945



MAIN FEATURES

Indoor / Outdoor installations

Aluminium painted with epoxy powder

12kg load rating

Autopan function with delayed inversion

Preset optional

Weatherproof standard IP66

DESCRIPTION

The PTH300 Pan & Tilt motor is suitable for medium duty outdoor installations with loads up to 12kg balanced. It is constructed from die cast aluminium construction protected by epoxypolyester painting.

It allows a maximum horizontal speed of 6°/s, a vertical speed of 3°/s and an horizontal rotation of 330°, vertical 360°. The Autopan function permits an automatic continual use of the horizontal rotation. A preset version is also available, equipped with potentiometers, which allows the preset by means of our telemetry systems.

Wide range of controllers are available, ranging from CBZ to the microprocessor controlled telemetry receivers and to the most advanced control keyboards of the range.



PTH300

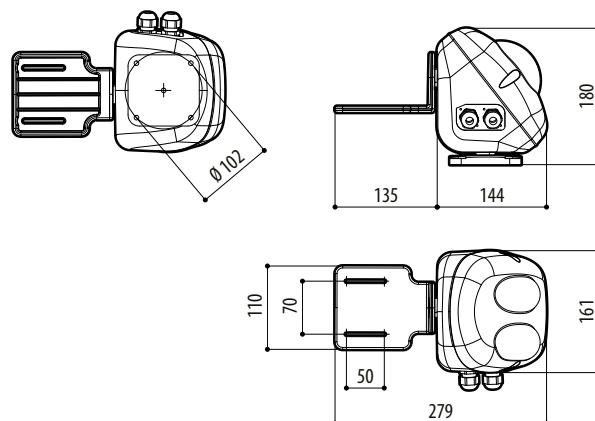

PTH300

mm 1:10

PTH300

AVAILABLE MODELS

Code	Power supply	Autopan	Preset	Max consumption
PTH310	230Vac	•		14W
PTH311	24Vac	•		14W
PTH310P	230Vac	•	•	14W
PTH311P	24Vac	•	•	14W

TECHNICAL DATA

GENERAL

Constructed from corrosion-proof aluminium
 Epoxypolyester powder painting, RAL9002 colour
 Stainless steel screws
 Mounting position normal / reverse
 Supplied with side bracket for camera housing, screws, accessories for mounting and instruction manual

MECHANICAL

Dimensions: 144x161x180mm (5.6x6.3x7in)
 Maximum load: 12kg (26lb) (balanced)
 0-330° horizontal plane movement
 6°/s fixed horizontal speed
 Pan Torque: 6Nm
 Internally adjustable horizontal limit switches
 0-360° vertical plane movement
 3°/s fixed vertical speed
 Tilt Torque: 6Nm
 Backlash: Pan 0.17°, Tilt 0.07°
 Internally adjustable vertical limit switches
 1 PG11 cable gland and 1 blanking cap for PTH300 models
 2 PG11 cable glands for PTH300P models

ELECTRICAL

Power supply 24/230Vac
 Horizontal motor consumption 7W max
 Vertical motor consumption 7W max
 Standard Autopan
 Preset potentiometer linear 5Kohm multitrans (10 turns)
 (only for PTH310P / PTH311P)

ENVIRONMENT

Indoor / Outdoor
 Operating Temperature: -20°C / +50°C (-4°F / 122°F)
 Resistant to salty fog until 1000 hours (according to ISO9227)

CERTIFICATIONS

CE EN61000-6-3, EN50130-4, EN60065
 IP66 EN60529
 196/PTAC Wall bracket for PTH300 P&T
 PTDC Ceiling bracket for PTH P&T series
 PTPC Top pole bracket for PTH P&T series
 WFWBTA Column bracket for PTH P&T series

RELATED PRODUCTS

CBZ220 Unit for direct control of one PTH310
 CBZ24 Unit for direct control of one PTH311
 MICRODEC485 Telemetry receiver 8 functions for PTH311
 DTMRX2 Telemetry receiver 12 functions for PTH310
 DTMRX224 Telemetry receiver 12 functions for series PTH311
 DTRX3 Telemetry receiver 17 functions for series PTH300 + preset
 DTRX324 Telemetry receiver 17 functions for PTH311 + preset
 Housings: HEA, HEB, HEK, HEM, HOV, HEP, VERSO, VERSO COMPACT

SPARE PARTS

OPH3MAN Maintenance kit
 DOTPTH300 Installation kit for P&T PTH300

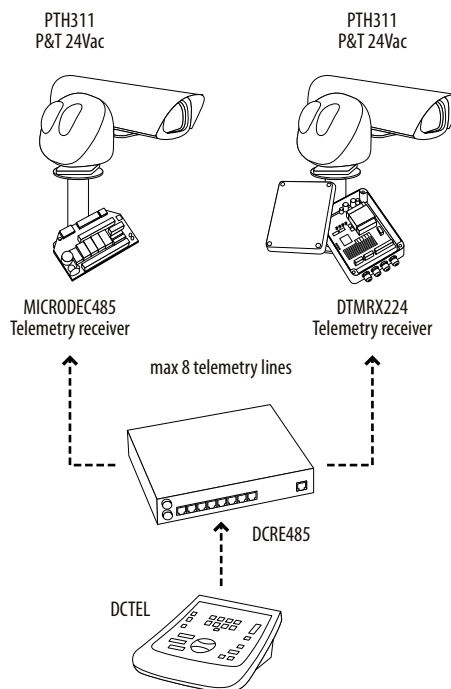

---> Twisted pair RS485 (max distance 1200m / 3937ft) telemetry only

PACKAGE

Code	Unit weight		Package weight		Package dimensions (WxHxL)		Master carton unit
	kg	lb	kg	lb	cm	in	
PTH300	3.7	8.2	4.1	9.0	17.5x27.0x23.0	6.9x10.6x9.0	6