

## MAIN FEATURES

### Germanium glass window

**AISI 316 stainless steel construction**

### For highly aggressive environments

**Supplied with sunshield and 230Vac heater**

**Weatherproof standard IP66/IP67**



NTM

## DESCRIPTION

The NTM housing, entirely constructed from AISI 316 electropolished stainless steel, is equipped with a Germanium viewing window designed for thermal camera installations. The clear Germanium glass composition with remarkable properties covers transmission from 7.5 to 14µm IR range with the best optical quality. The window dimension allows the installation of different cameras/lens combination.

NTM is designed to operate in special environments such as marine, industrial, chemical and where the external agents are highly corrosive.

The housing consists of a 130mm diameter cylindrical body enclosed by two 9mm thick circular flanges. The back flange is equipped with two PG13.5 cable glands for the external connections.

A wide range of accessories is available: sunshield, heater, stainless steel brackets and wiper-washer.

## AVAILABLE MODELS

Code	Sunshield	Power supply 230Vac	Power supply 24Vac	Ø Germanium Glass
NTM1K1000	•	•		55mm

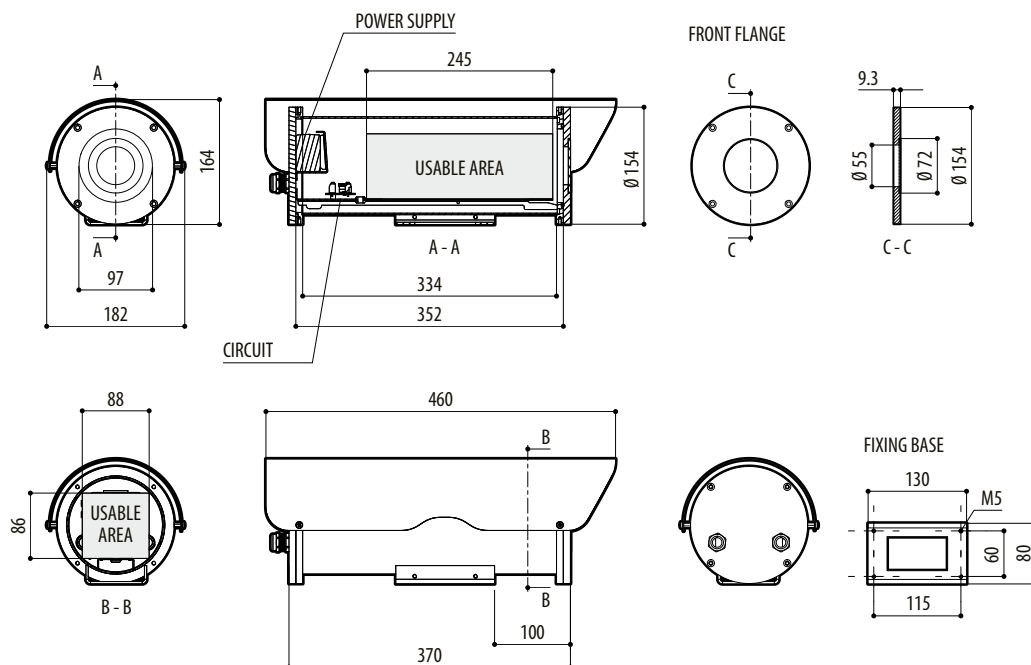

NTM

## TECHNICAL DATA

## GENERAL

Constructed from electropolished stainless steel (Austenitic alloy stainless steel, corrosion and heat resistant according to the following standards):

- UNI 6900-71: X 2 Cr Ni Mo 17 12
- AISI: 316
- DIN 17006: X 2 Cr Ni Mo 18 10
- N° WERKSTOFF: 1.4404
- AFNOR: Z2 CND 17-12
- BSI: 316 S 12

The screws utilised are in austenitic alloy stainless steel, corrosion and heat resistant according to the following standards:

- UNI 6900: X 5 Cr Ni Mo 1712
- AISI: 316
- ISO quality: A4
- Resistance class ISO: 80

Supplied with instruction manual, desiccant bag, accessories for camera and lens mounting

UNI: Ente Nazionale Italiano di Unificazione, AISI: American Iron and Standard Institute, DIN: Deutsche Industrie Normen, AFNOR: Association Française de Normalisation, BSI: British Standard Institution, ISO: International Organization for Standardization.

## MECHANICAL

2 cable glands: 2xPG13.5 in nickel-plated brass for external connections

External body polishing

9mm (0.3in) thick front and back flange

O-ring gaskets

Internal usable area (WxH): 88x86mm (3.5x3.4in)

Internal usable length

NTM 334mm (13.1in)

Internal usable length with heater and/or power supply

NTM 245mm (9.6in)

## GERMANIUM GLASS WINDOW

2mm (0.07in) thick, Ø 70mm (2.8in) external, Ø 55mm (2.1in) internal

External non-scratch treatment (hard carbon coating)

Internal antireflection treatment

Spectral range from 7.5 to 14µm IR range

Average transmission from 7.5 to 11.5µm, 94%

Average transmission from 11.5 to 14µm, 90%

## WIPER

Wiperblade and enclosure constructed from AISI 316 stainless steel

Dimensions (ØxL): 100x169mm (3.9x6.6in), not comprehensive of blade

Connector 3+1 pins

IN 230Vac, consumption 7W max

IN 24Vac, consumption 7W max

## ELECTRICAL

Heater Ton 15°C±3°C (59°F±5°F) Toff 22°C±3°C (71°F±5°F)

- IN 12Vdc/24Vac, consumption 20W max
- IN 115/230Vac, consumption 40W max

Camera power supply

- IN 100-240Vac - OUT 12Vdc, 50/60 Hz, 1A
- IN 230Vac - OUT 24Vac, 50/60Hz, 400mA

## ENVIRONMENT

Indoor / Outdoor

Operating temperature with heater: -20°C / +60°C (-4 / +140° F)

## CERTIFICATIONS

## NTM

CE EN61000-6-3, EN60065, EN50130-4

IP66/IP67 EN60529

## VIPNX

CE EN61000-6-3, EN60065, EN50130-4

IP66 EN60529

## ACCESSORIES

ONXMAS6	Sunshield
OHEH06B	Heater 115/230Vac
OHEH05B	Heater 12Vdc/24Vac
ONXPS1B	Wide range camera power supply IN 100-240Vac - OUT 12Vdc, 1A
ONXPS2B	Camera power supply IN 230Vac - OUT 24Vac, 400mA
VIPNX1C	Wiper 230Vac
VIPNX2C	Wiper 24Vac
VIP5WAS01	Tank 5l (1,3gal), 230Vac washer pump
VIP5WAS02	Tank 5l (1,3gal), 24Vac washer pump
VIP23WAS01	Tank 23l (6gal), 230Vac washer pump
VIP23WAS02	Tank 23l (6gal), 24Vac washer pump
VIP23WASA01	Tank 23l (6gal), 230Vac washer pump, high delivery up 30m
UPTWAS01C	Tank 23l (6gal), IN 230Vac washer pump (prearranged for DTWRX board)
UPTWAS02C	Tank 23l (6gal), IN 24Vac washer pump (prearranged for DTWRX board)
UPTWAS03C	Tank 23l (6gal), IN 120Vac washer pump (prearranged for DTWRX board)
UPTWASA01C	Tank 23l (6gal), IN 230Vac washer pump, high delivery up 30m (98ft) (prearranged for DTWRX board)
UPTWASA03C	Tank 23l (6gal), IN 120Vac washer pump, high delivery up 30m (98ft) (prearranged for DTWRX board)
DTWRX	Optional board for remote control of wiper and washer pump of the UPTWAS series

## BRACKETS AND ADAPTORS

NXWBS1	Wall bracket for stainless steel housing
--------	--

## RELATED PRODUCTS

NXPTH	Stainless steel Pan&Tilt
-------	--------------------------

## SPARE PARTS

ONXMMAN	Maintenance kit NTM housing
OSPAVIPNXM	Complete wiper blade for VIPNX
ONTMFA	Complete NTM front cover

## PACKAGE

Code	Unit weight		Package weight		Package dimensions (WxHxL)		Master carton
	kg	lb	kg	lb	cm	in	
NTM	6.0	13.2	10.2	22.5	24.5x24.5x62.0	9.7x9.7x24.1	-
VIPNX	1.7	3.7	1.9	4.2	14.5x15.0x27.0	5.7x5.9x10.6	-